

# IMS Building Solutions for the Future



The information contained herein is proprietary to Innovative Modular Solutions and may not be used, reproduced, or disseminated without written consent.

## Challenge:

Without a building or construction levy passed by voters since 1964, and with continuous enrollment growth, 260 students in the public school district were being involuntarily bused to schools outside their neighborhoods at a cost of \$40,000 per year. In addition, school officials believed that some parents and students were leaving the district due to overcrowding. The district and its architect worked to determine the best solution for students and staff. A plan was proposed that would add 8 new classrooms at the elementary school where neighborhood children had been bused to other schools for the past 6 years. Each new classroom would support 25 to 27 students and be wired for technology to include computers and the Public Address system.

## Alternatives Reviewed:

1. Do nothing due to budget constraints — not feasible as overcrowding impacted the educational outcome for students.
2. Construct a traditional, site built building addition — not feasible due to lack of funding and the time required for site built construction. There was an immediate need for additional classroom space.
3. Install four 2-classroom buildings or eight 1-classroom buildings— not feasible due to limited school ground space and 30 - 40% higher temporary construction costs to connect site utilities and technology for 4 to 8 separate structures.
4. Install one 8-classroom, modular building — the Innovative Modular Solution.

## Solution:

Public bids were solicited and the District contracted with Innovative Modular Solutions (IMS). IMS provided an energy-efficient, 8,600 square foot modular building that includes 8 climate controlled, 28' x 30' classrooms, separate restroom areas for boys, girls and teachers and a wet area for use by custodians. Construction was completed during the summer. Students occupied the building in time for the beginning of Fall semester.

- Most students in the district can now attend their home schools. Parental satisfaction is improved.
- Transportation cost savings transferred into the general fund for other improvements to education in the district.
- The need for additional permanent space remains at the elementary school and other schools in the district. The modular classrooms, however, ease the crowding and help improve education for the next four to five years.

*We would appreciate the opportunity to  
earn your business.*



Offices in IL, IN, MI, MN and OH  
Phone: 1-800-357-4699  
Website: [www.innovativemodular.com](http://www.innovativemodular.com)  
E-mail: [schools@innovativemodular.com](mailto:schools@innovativemodular.com)

# Modular Building Case Study

## Public Elementary School



The information contained herein is proprietary to Innovative Modular Solutions and may not be used, reproduced, or disseminated without written consent.

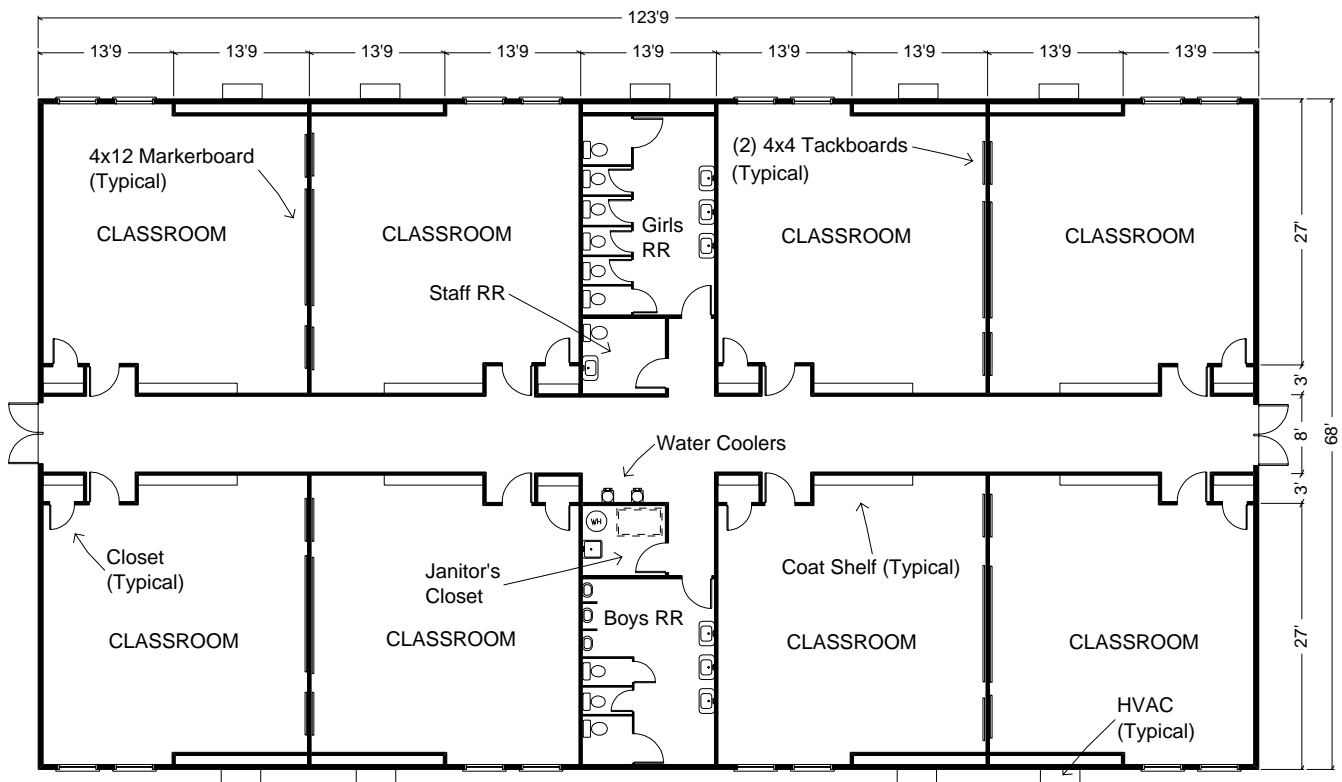

Our goal is to provide customer-focused, professional service that will exceed your expectations.



Offices in IL, IN, MI, MN and OH  
 Phone: 1-800-357-4699  
 Website: [www.innovativemodular.com](http://www.innovativemodular.com)  
 E-mail: [schools@innovativemodular.com](mailto:schools@innovativemodular.com)

Permanent or Temporary Building Solutions